

Roller Shutter Installation Manual



Pre-Installation Guidelines

Please read the entire manual for proper installation, as this can also help you avoid scratching or causing other potential damage to your car. Regularly inspect and retighten all hardware and clean the product to maintain its original appearance.

Parts List

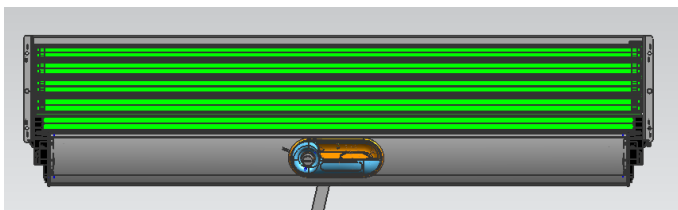
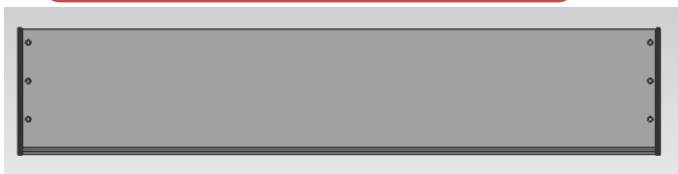
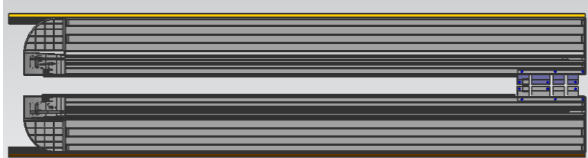
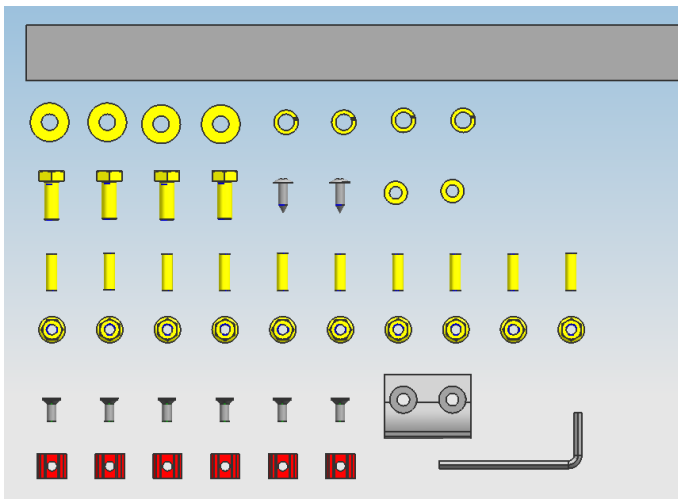
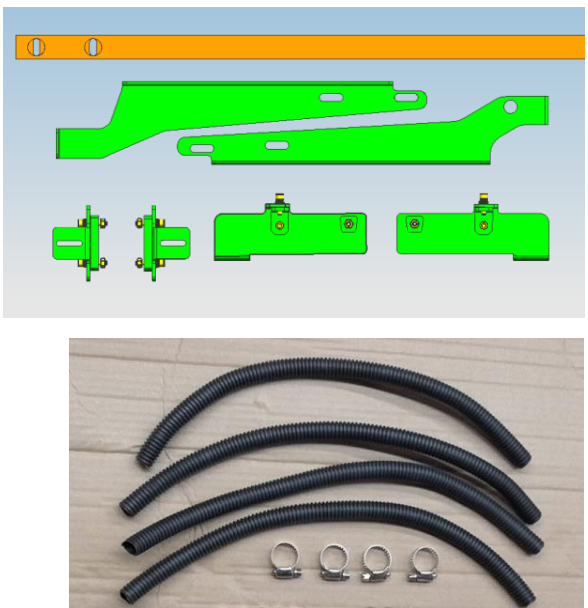
 <p>Casing and Shutter Assembly</p>  <p>Aluminum Cover</p>	 <p>Side Guide Rails (Left and Right)</p>
 <p>Accessory Kit</p>	 <p>Installation Brackets Baffle Pipe Drainage Pipe Throat Clamp</p>

Installation Steps

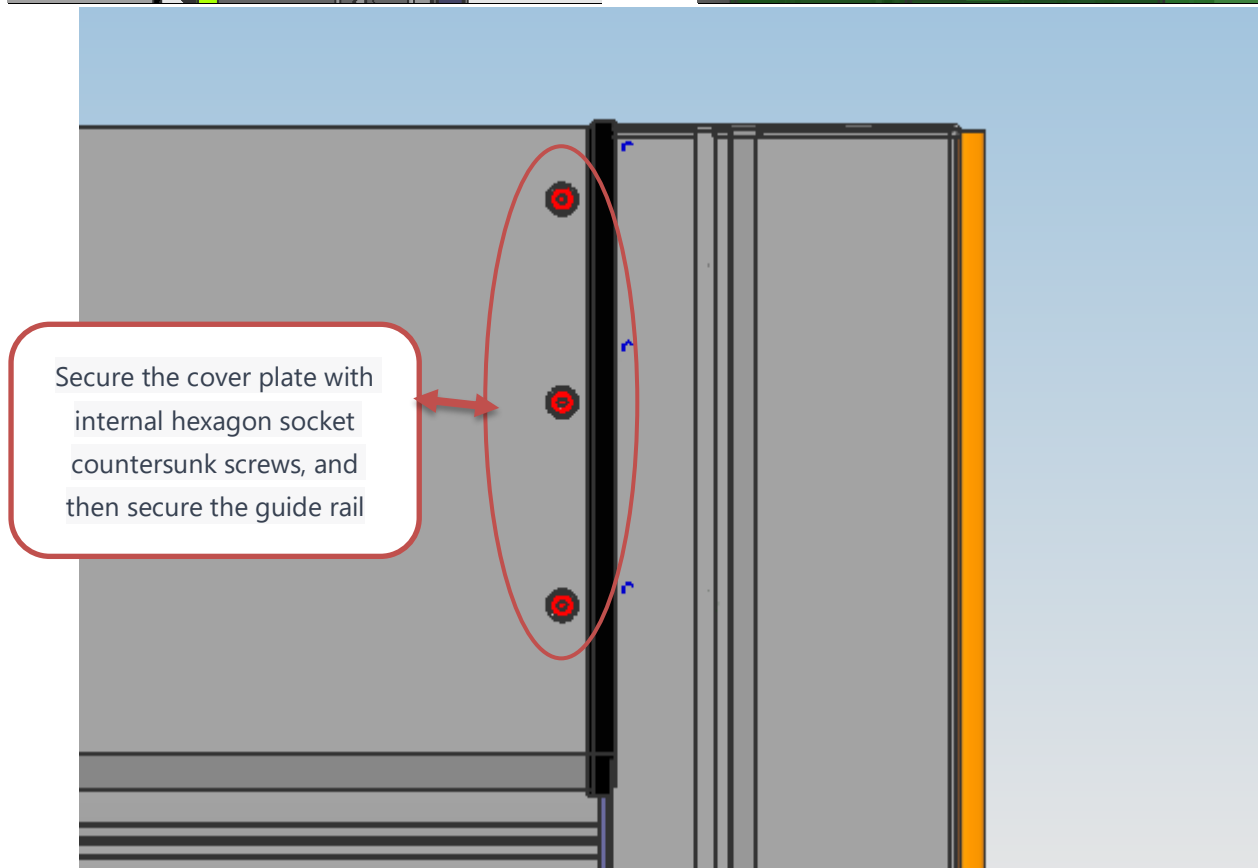
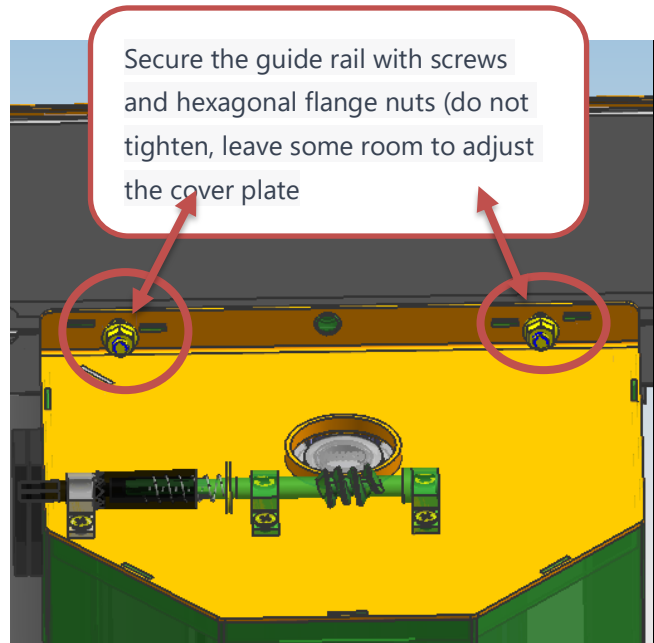
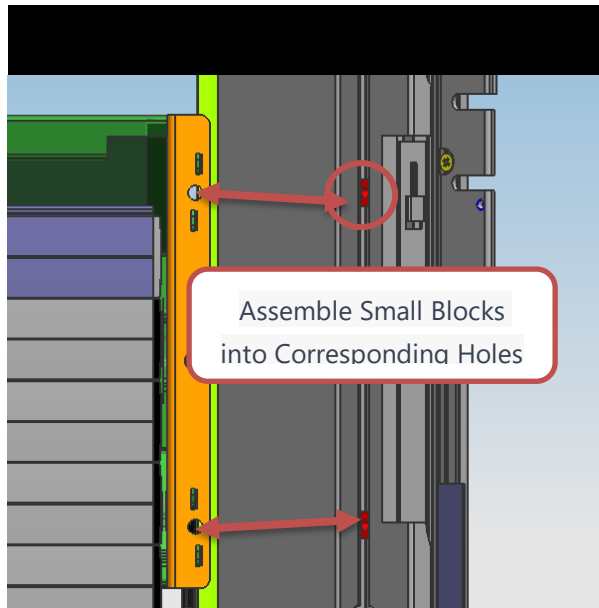

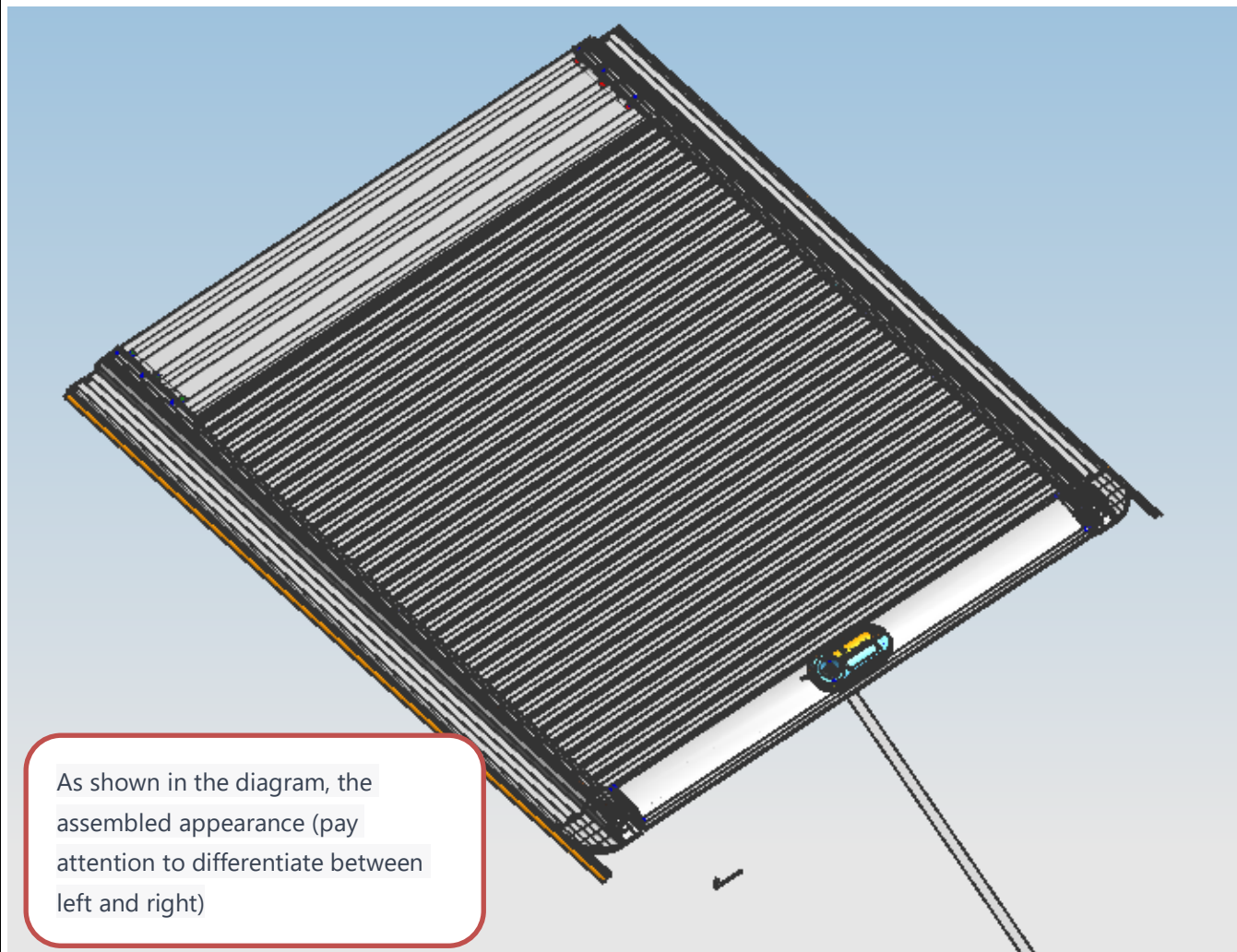

As shown in the diagram, the assembled appearance (pay attention to differentiate between left and right)

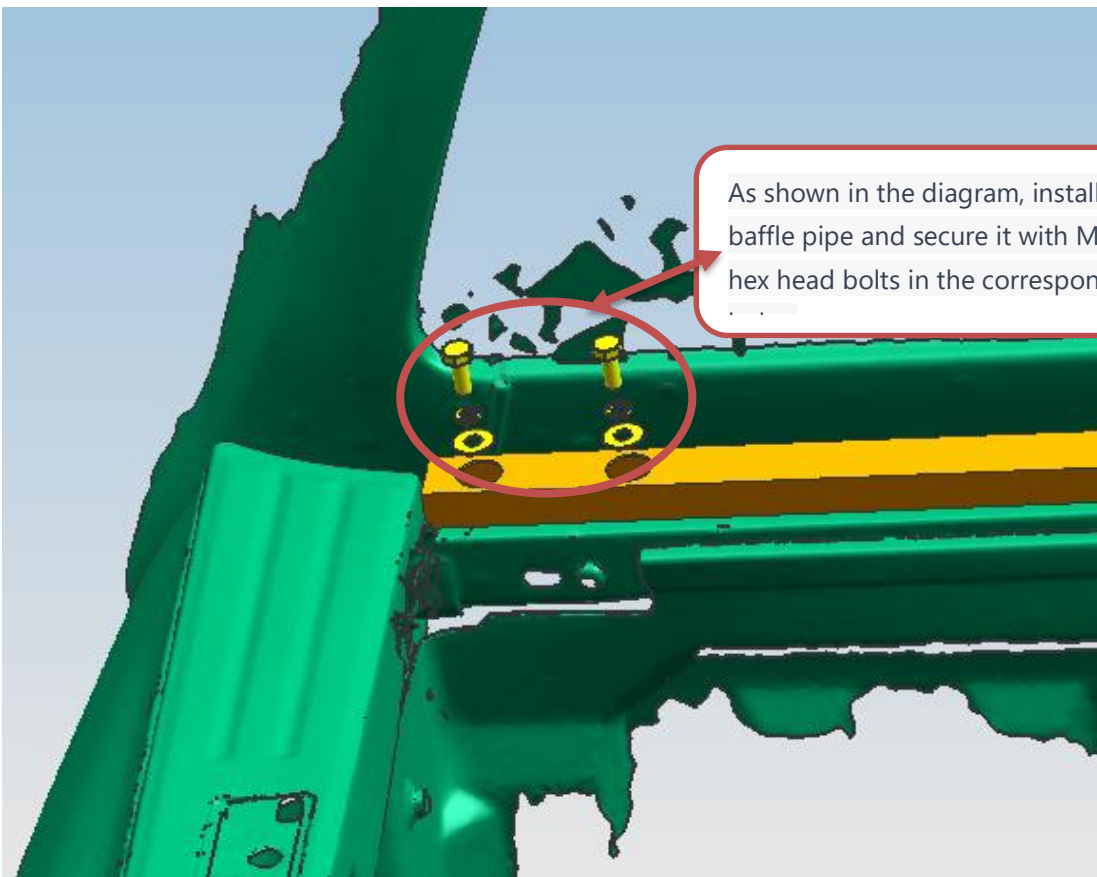

As shown in the diagram, install the baffle pipe and secure it with M820 hex head bolts in the corresponding

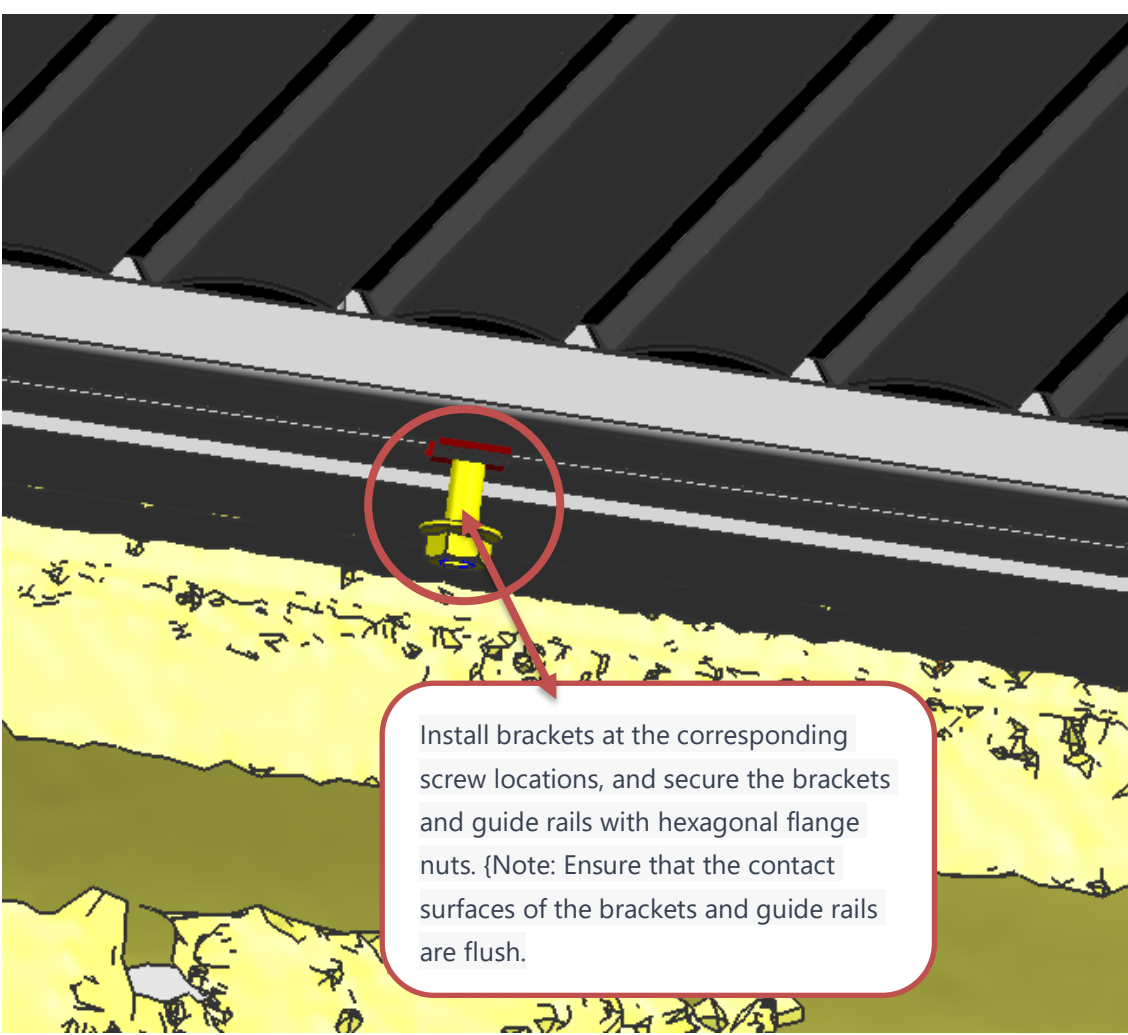

Install brackets at the corresponding screw locations, and secure the brackets and guide rails with hexagonal flange nuts. {Note: Ensure that the contact surfaces of the brackets and guide rails are flush.

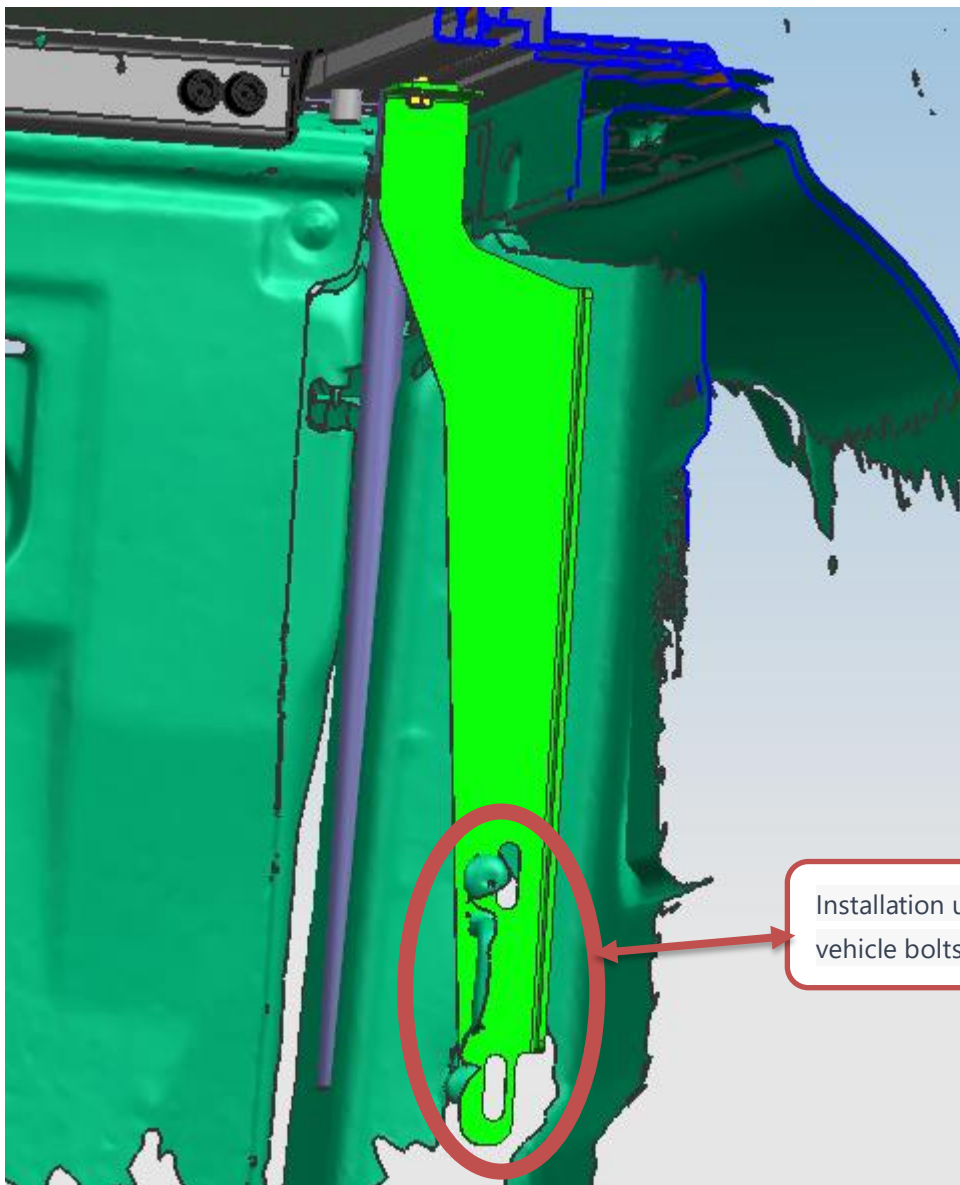
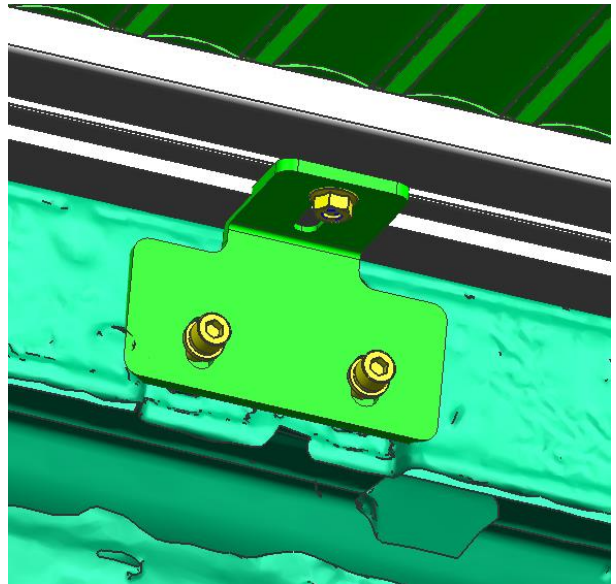
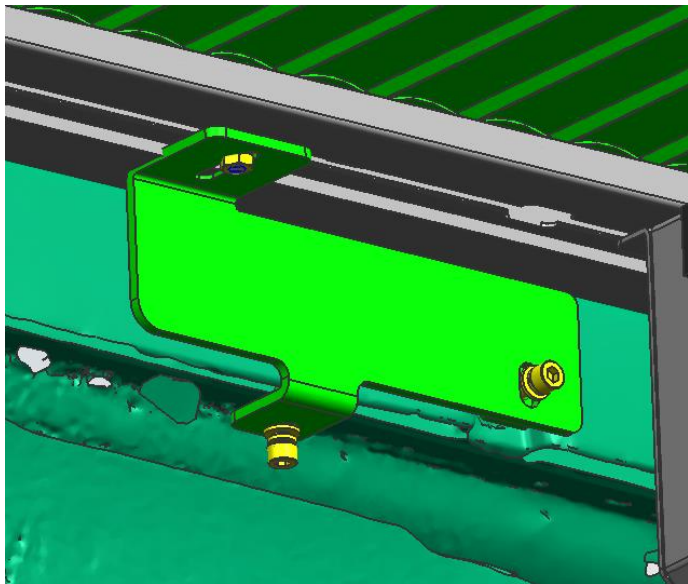

Installation using the original vehicle bolts