

# INSTALLATION INSTRUCTION

ITEM NO.: W4-JT-SBAR

DESCRIPTION: ROLL BAR FOR JEEP GLADIATOR 2021

Attention:

- Please read this installation menu before installing this part. Protect your car properly in case there is any scratch might have.
- You may need to periodically to re-tighten all hardware for safety use after installation.
- Installation pictures are only for your reference, there might be some differences between pictures and real parts but no affect for your fitting.

## PART LIST

No.	Name	Qty	Remark	No.	Name	Qty	Remark
1	Middle Main Pipe	1		15	Internal Hexagon Flat Round Head Screw	18	M8*30
2	Front Main Pipe (Left)	1		16	Large Washer	28	Φ8*25*2.0
3	Front Main Pipe (Right)	1		17	Spring Washer	28	Φ8
4	Side Bend Pipe (Left)	1		18	Hexagon Flange Nut	14	M8
5	Side Bend Pipe (Right)	1		19	Internal Hexagon Flat Round Head Screw	2	M10*40
6	Side Plate (Left)	1		20	Internal Hexagon Countersunk Screw	4	M10*35
7	Side Plate (Right)	1		21	Flat Washer	2	Φ10*20*2.0
8	Bottom Plate	2		22	Spring Washer	10	Φ10
9	Luggage Rack	1		23	Hex Bolt	8	M10*40
10	Support Plate 1	2		24	Large Washer	8	Φ10*30*2.5
11	Connecting Bracket 1	2		25	Flat Head Rivet Nut	8	M10
12	Connecting Bracket2 (Left)	1		26	Hex Key	1	S=5
13	Connecting Bracket2 (Right)	1		27	Hex Key	1	S=6
14	Internal Hexagon Flat Round Head Screw	10	M8*20				

## INSTALLATION PICTURE

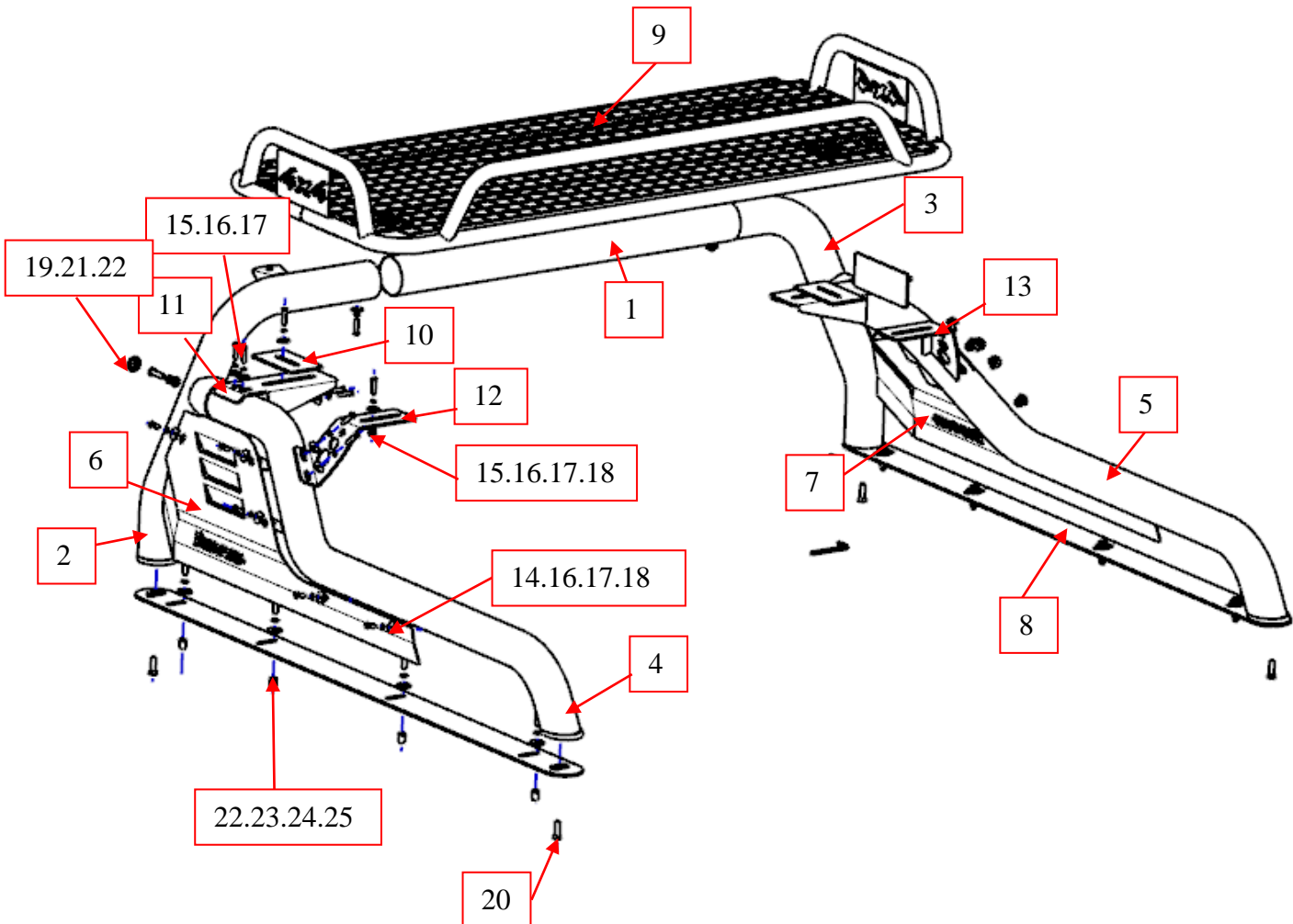

## INSTALLATION STEPS

Step 1: Refer to the part list and installation picture to check if all hardware are included.

Step 2: Tighten and install the side plates (left/right) onto the front main pipe (left/right) and the side bend pipe (left/right). Next, connect the connecting bracket to the main pipes and lock it in place, then secure the luggage rack to it. Finally, screw the bottom plate onto the installed front/side main pipes using m10x35 hexagon socket countersunk screws.

Step 3: First, drill a  $\Phi 13.8$  hole, then insert an M10 flat head rivet nut. Finally, use an M10x40 hex head bolt to tighten the ROLL BAR bottom plate to the carriage.

Step 4: Check if all hardware are installed and tighten all to complete the installation.

PIC.1

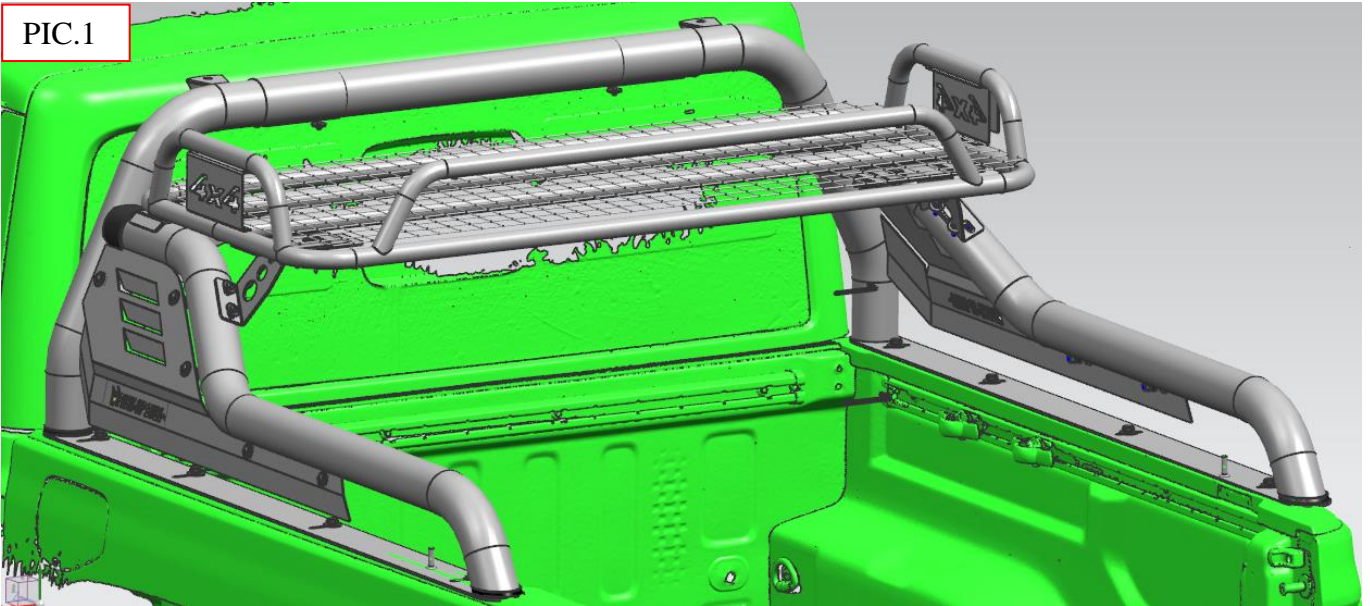

PIC.2

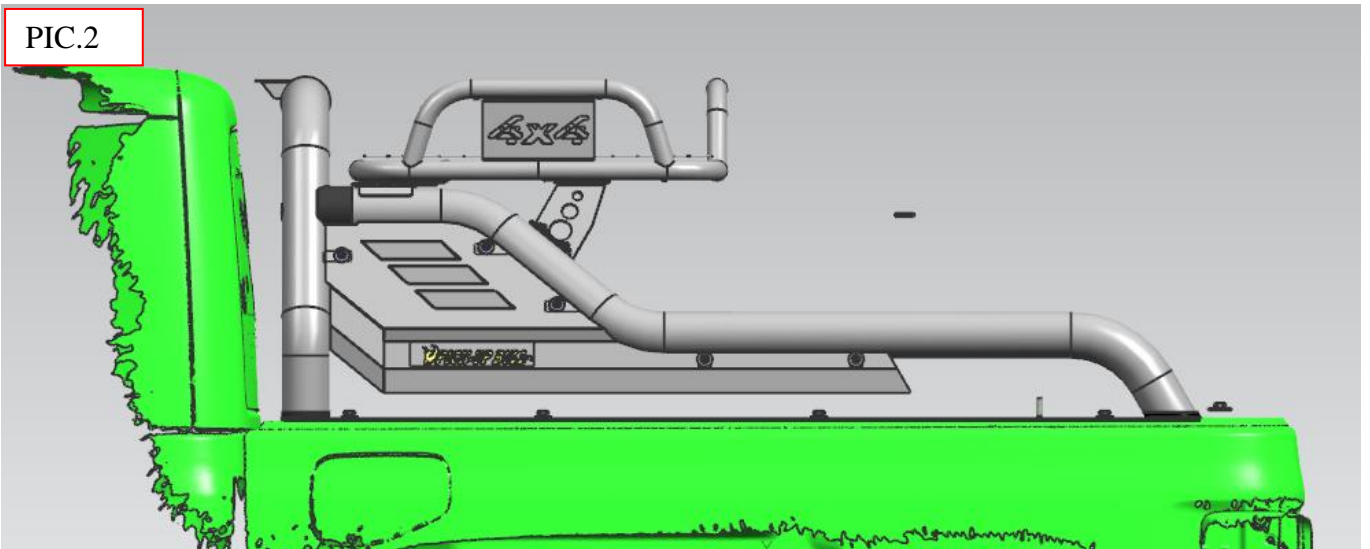

Disclaimer: Caused due to improper installation initiates or some related problem and losses, are beyond our company's quality assurance.