

INSTALLATION INSTRUCTION

ITEM NO.:W4-SPBAR-H-UNI

DESCRIPTION: 4x4 Roll Sports Bar Role with LED Lights Suits Ranger Hilux BT50 Navara Triton Universal

ATTENTION:

- Please read this installation menu before installing this part. Protect your car properly in case there is any scratch might have.
- You may need to periodically to re-tighten all hardware for safety use after installation.
- Installation pictures are only for your reference, there might be some differences between pictures and real parts but no affect for your fitting.

PART LIST:

NO.	NAME	QTY	REMARK	NO.	NAME	QTY	REMARK
1	Side plate (L)	1		11	Open core rivets	28	D4*16
2	Side plate (R)	1		12	Flat Washer	6	Φ10*30*2.5
3	decorative parts1	2		13	Spring Washer	6	Φ10
4	decorative parts2 (L)	1		14	Hexagon Nut	6	M10
5	decorative parts2 (R)	1		15	Hexagon socket button head screws	8	M8*20
6	LAMP BOARD	1		16	Large Washer	8	Φ8*25*2.0
7	LED LIGHT	2		17	Spring Washer	8	Φ8
8	Break LIGHT	1		18	Hexagon flange nuts	8	M8
9	PVC PLATE	2		19	T-bolt	6	18*32*4.0
10	Cross groove pan head self tapping screw	2	ST5*16	20	socket head wrench	1	S=5

INSTALLATION PICTURE

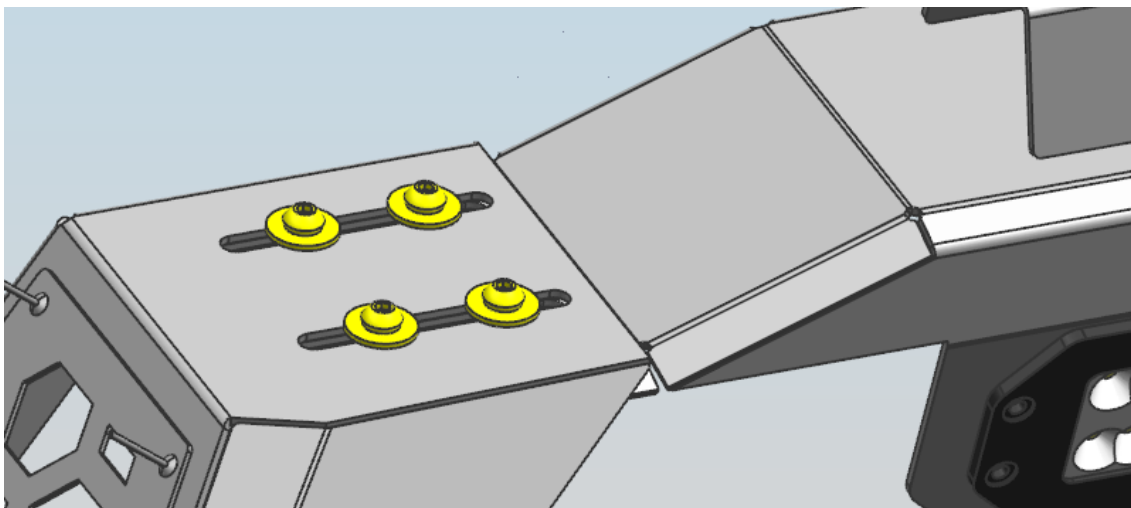
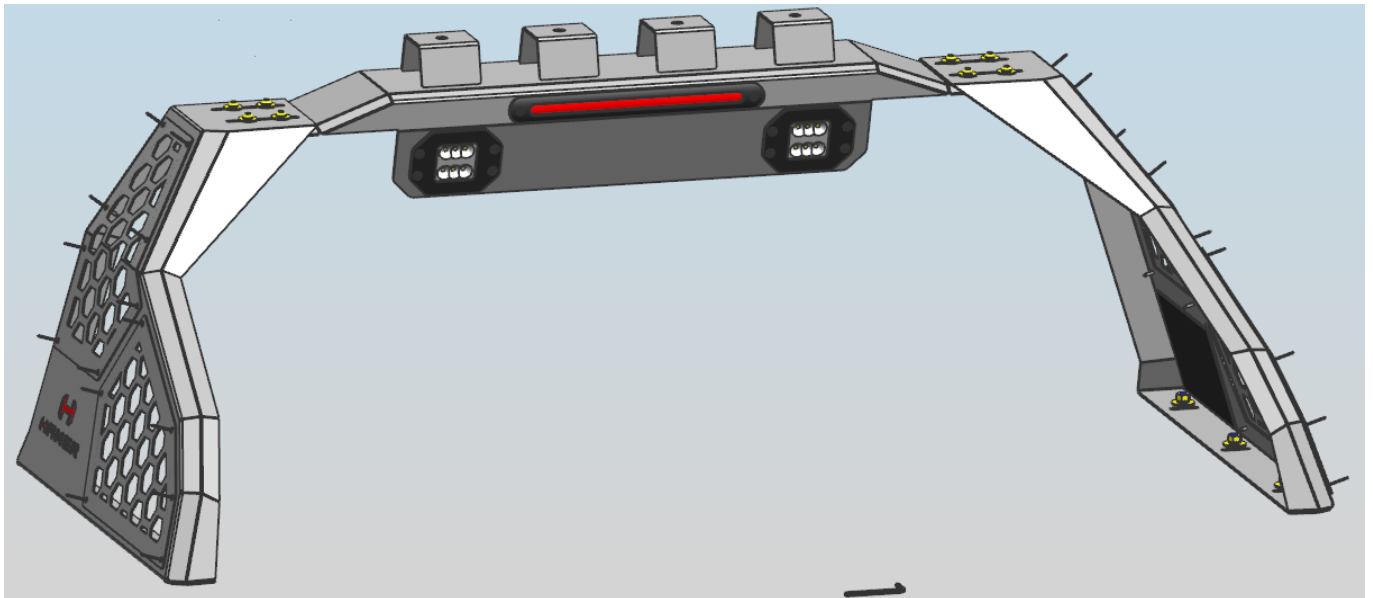

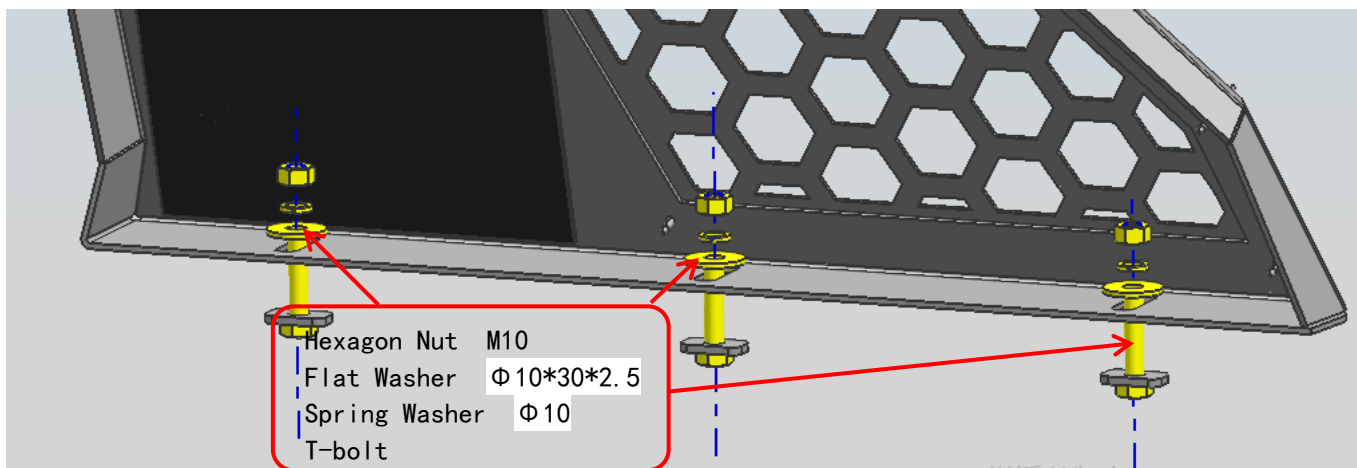
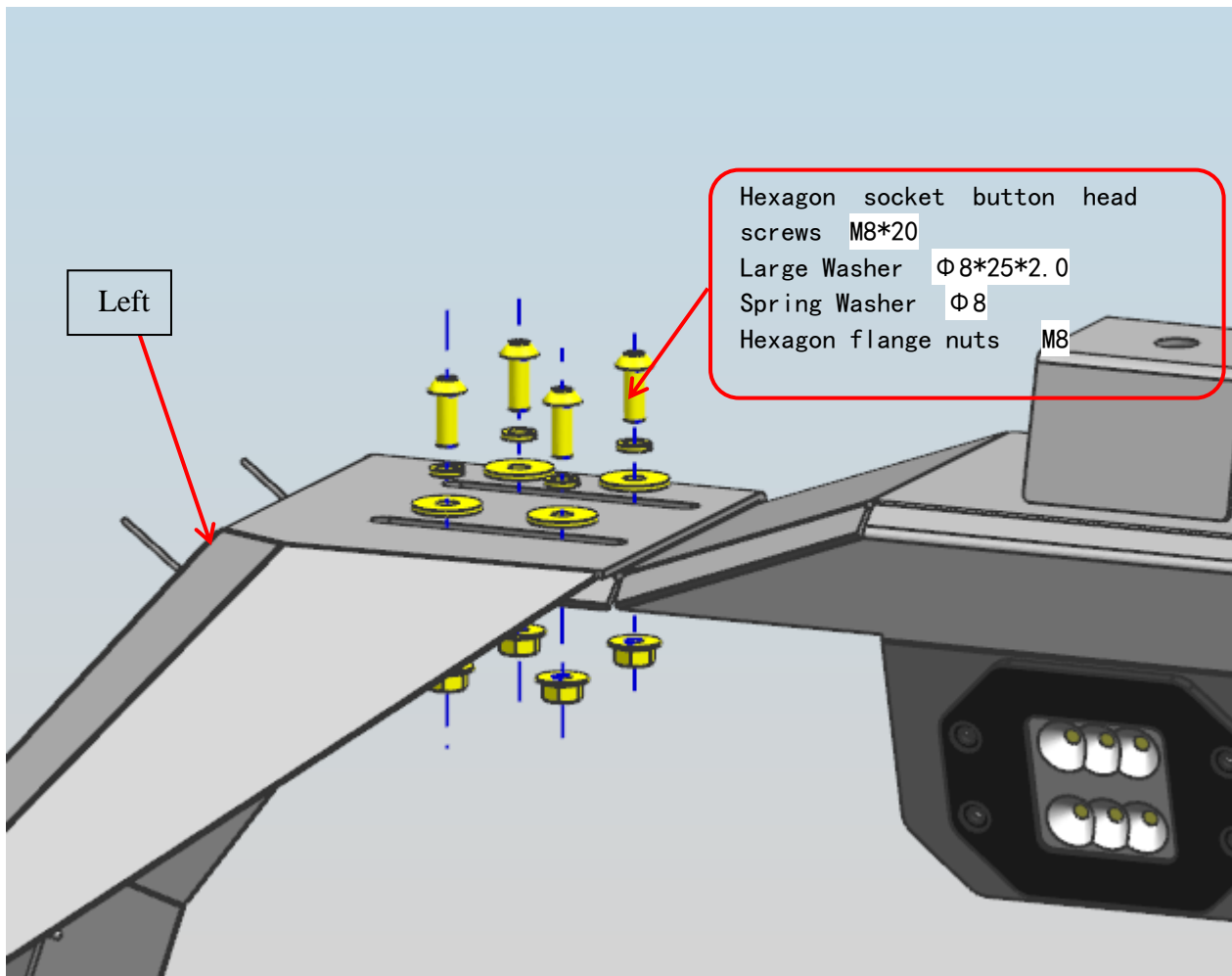

INSTALLATION PROCEDURE

Step 1: Refer to Part List to check if all hard ware are included.

Step 2: As shown in the figure, lock and install the side body and connecting plate according to the corresponding standard parts in different figures. Next, install the baffle and side body to complete the assembly of the anti rollover frame.

Step 3: Check if all hard ware are installed and then fasten all to complete the installation. .

Disclaimer: Caused due to improper installation initiates or some related problem and losses, are beyond our company' s quality assurance.