

# INSTALLATION INSTRUCTION

ITEM NO.:W4-UNI-SPBAR-V2

DESCRIPTION:UNIVERSAL ROLL BAR FOR JAPANESE PICK UP

ATTENTION:

- Please read this installation menu before installing this part. Protect your car properly in case there is any scratch might have.
- You may need to periodically to re-tighten all hardware for safety use after installation.
- Installation pictures are only for your reference, there might be some differences between pictures and real parts but no affect for your fitting.

## PART LIST

NO.	NAME	QTY	REMARK	NO.	NAME	QTY	REMARK
1	Front bar	1		11	Spring Washer	10	(65Mn)φ10
2	REAR BAR (L)	1		12	Flat head rivet nut	4	M10 color zinc plating
3	REAR BAR (R)	1		13	Large Washer	8	φ10*30*2.5
4	Side plate (left)	1		14	Flat Washer	2	φ10*20*2.0
5	Side plate (right)	1		15	Hexagon Bolt	8	(45#) M10*35
6	Connecting bracket (L)	1		16	Hexagon socket button head screws	2	(45#) M10*40
7	Connecting bracket (R)	1		17	Hexagon socket button head screws	24	(45#) M8*30
8	ROOF RACK	1		18	Hexagon Nut	6	(35#) M8
9	mounting bracket (L)	1		19	Flat Washer	30	φ8*20*2.0
10	mounting bracket (R)	1		20	Spring Washer	24	(65Mn)φ8
21	Allen key	1	45#S=6(L=80)	22	Allen key	1	45# S=5(L=67)

## INSTALLATION PICTURES

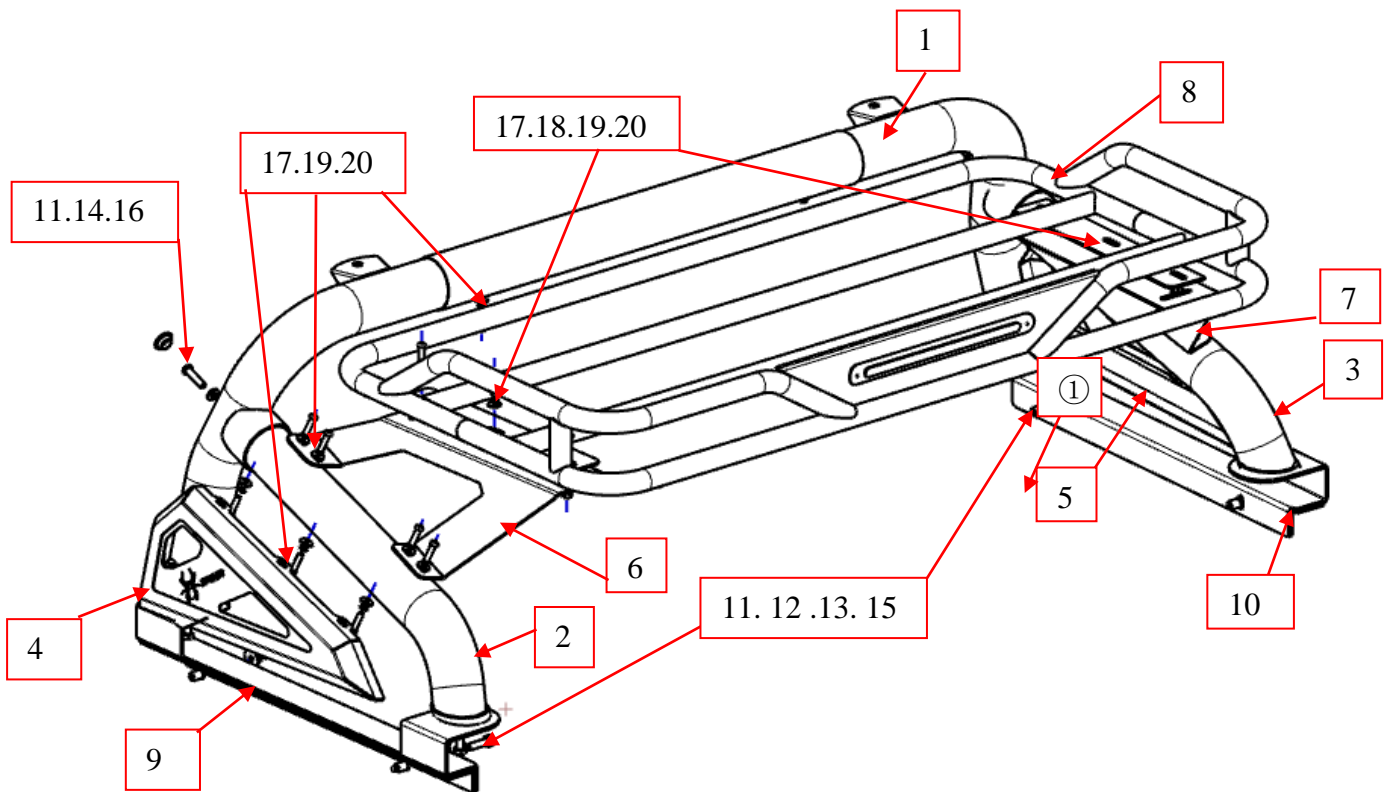

## INSTALLATION PROCEDURE

Step 1: Refer to Part List to check if all hard ware are included.

Step 2: As shown in the above figure, lock and install the side plate with the front and rear bars according to the corresponding standard parts in different figures. Next, screw the bottom plate onto the installed front and rear bars, and tighten them with M8x30 Hexagon socket button head screws.

Step 3: Drill a  $\Phi$  13.8 hole, then drive an M10 flat head rivet nut and tighten the anti rollover frame bottom plate with an M10 \* 35 hex head bolt

Step 4: Check if all hard ware are installed and then fasten all to complete the installation.

Step 5: Easy Install refer Pic 2.

Pic 2

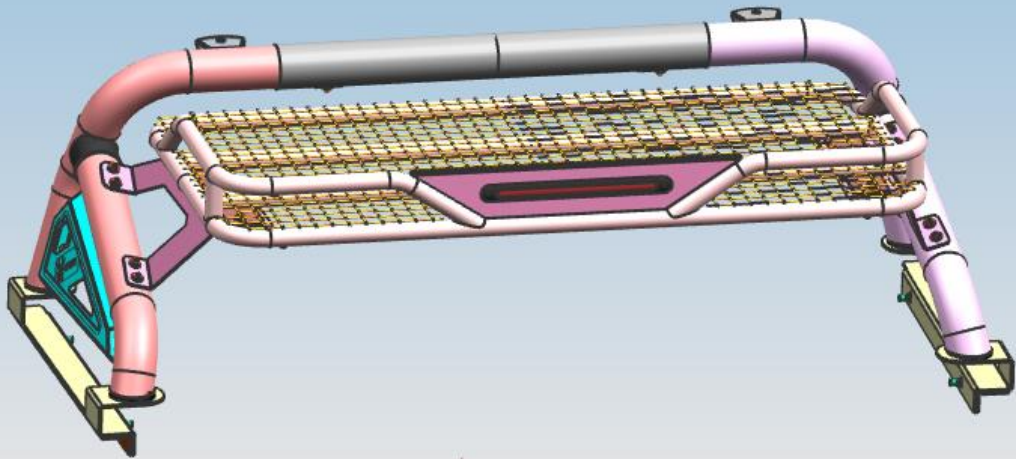

**Disclaimer: Caused due to improper installation initiates or some related problem and losses, are beyond our company' s quality assurance.**